



## HISTORY

Built by the fashionable architect John Verge, Elizabeth Bay House is an example of colonial architecture in a magnificent setting overlooking Sydney Harbour. Occupied by the Colonial Secretary, Alexander Macleay, and his family between 1839 and 1845, it was known as the 'finest house in the colony'. The house has been elegantly furnished to the Macleay period and is an excellent venue for business events, intimate dinners, cocktail parties, wedding ceremonies and receptions, and film and photography.



## HALL & SALOON

The saloon features a majestic domed ceiling and an elegant cantilevered staircase, providing an atmospheric space for a sit down dinner for up to 40 guests, or a cocktail party or wedding ceremony for up to 100 guests. While visiting the house, guests have the opportunity to experience the unique surroundings by viewing the period exhibition rooms with their exquisite 19th-century furnishings. Some of the exhibition rooms available for viewing include the dining room, drawing room, library and bedrooms.

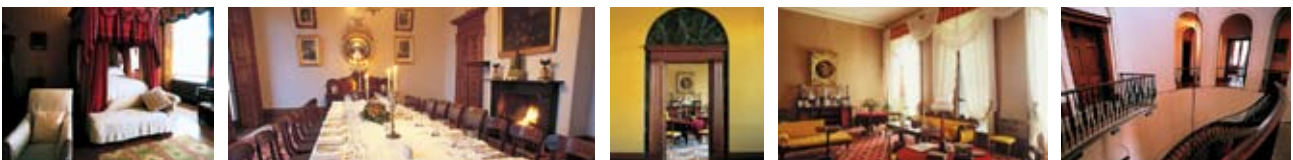

## DINING ROOM

The Dining Room seats up to 24 guests at an antique mahogany table. An original working fireplace, high ceilings and period furnishings add to the unique atmosphere. The adjoining sandstone verandah with sweeping views of Sydney Harbour is the ideal setting for pre-dinner drinks. The cellar, with its vaulted and beamed ceilings, sandstone walls and floors, is the perfect space in which to serve dessert by candlelight.

# HHT venues | ELIZABETH BAY HOUSE

	CAPACITY	TIME	FEE <sup>1</sup>	INCLUSIONS
HALL & SALOON <sup>2</sup>	32 CABARET	9AM – 5PM <sup>4</sup>	\$1600	<ul style="list-style-type: none"> <li>• Event Coordinator &amp; Supervisor</li> <li>• 3 ft drop tables</li> <li>• Tables (6ft oval)</li> <li>• Chairs</li> </ul>
	40 BANQUET	5.30PM – 10.30PM	\$1900	
	100 COCKTAILS	5.30PM – 9.30PM	\$1900	
	WEDDING CEREMONY	4.30PM – 6.30PM	\$1400	
	CAPACITY	TIME	FEE <sup>1</sup>	INCLUSIONS
DINING ROOM   CELLAR <sup>3</sup>	24 BOARDROOM	9AM – 5PM <sup>4</sup>	\$1400	<ul style="list-style-type: none"> <li>• Event Coordinator &amp; Supervisor</li> <li>• Dining table &amp; chairs</li> <li>• 3 ft drop tables</li> <li>• Denon audio system</li> </ul>
	24 BANQUET	6PM – 11PM	\$1900	
	CELLAR		\$450 <sup>3</sup>	
	WEDDING PHOTOGRAPHY	AFTER HOURS	\$330	<ul style="list-style-type: none"> <li>• Museum representative</li> </ul>
<p>1. ALL PRICES INCLUDE GST, 20% SURCHARGE APPLICABLE ON SUNDAYS AND PUBLIC HOLIDAYS. VENUE HIRE FEES ARE VALID UNTIL 31 MARCH 2009</p> <p>2. HALL &amp; SALOON NOT RECOMMENDED FOR JUNE, JULY &amp; AUGUST DUE TO COLD CONDITIONS</p> <p>3. CELLAR HIRED IN CONJUNCTION WITH DINING ROOM</p> <p>4. AVAILABLE MONDAY–THURSDAY ONLY</p>				

## CATERING

Food and beverage services are available exclusively by the award-winning Avocado Group. The Catering Manager will work with you to design a catering package that meets your event requirements. Please note that due to conservation requirements to prevent permanent damage to the original sandstone flooring, red wine can only be served while guests are seated in the dining room for banquet events and not at cocktail events.

### Avocado Group

T 02 9882 3244 | F 02 9882 3266 | E [avocado@avocadogroup.com.au](mailto:avocado@avocadogroup.com.au) | W [www.avocadogroup.com.au](http://www.avocadogroup.com.au)

## MUSIC

To complement the surroundings of the property clients have engaged string groups to play background music. We can recommend a selection of string groups and musicians who have worked successfully across HHT venues. Due to the Environmental Protection Authority noise guidelines, amplification is permitted for vocals only. No DJs or amplified bands are permitted.

## AUDIOVISUAL

HHT venues can make available a diverse range of in-house audiovisual equipment to meet your event requirements. For further details please contact HHT venues.

# HHT venues | ELIZABETH BAY HOUSE

## PARKING

There is no on-site parking at Elizabeth Bay House. Conveniently located parking and transport include:

### Secure Parking

Corner Ward Ave, & Elizabeth Bay Rd, Kings Cross, NSW 2011 **T** 02 9358 5000. Open 24 hours 7 days (closest parking)

### By bus

The 311 travels from Circular Quay and stops close to the front door. The Sydney Explorer Bus stops on Macleay Street, a short walk to the house.

### By train

The house is a seven-minute walk from Kings Cross station.

## MAP

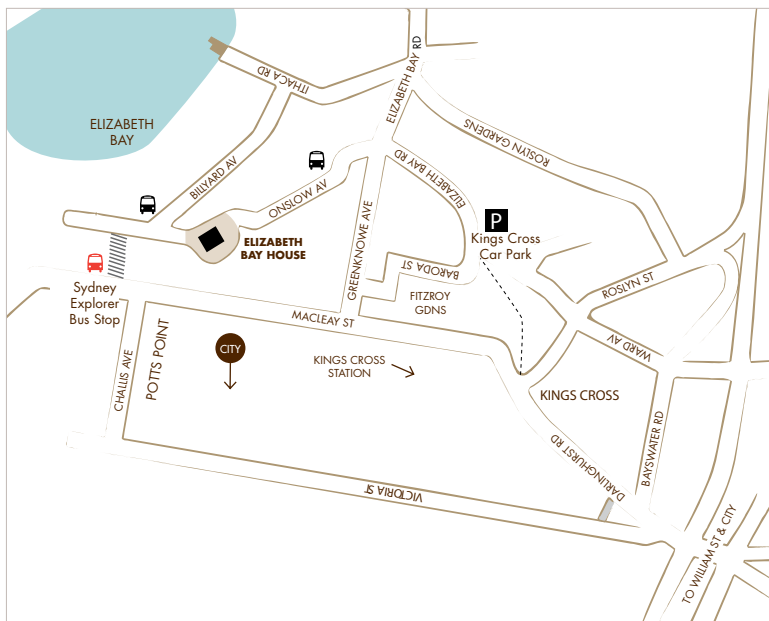

## CONTACT

For more information regarding Elizabeth Bay House, or other HHT venues please contact:

**Sales & Marketing Coordinator | HHT venues | Historic Houses Trust**

The Mint, 10 Macquarie Street, Sydney, NSW 2000

**T** +61 2 8239 2288 | **F** +61 2 8239 2400 | **E** venues@hht.net.au | **W** www.hhtvenues.com.au

## SITE PLAN

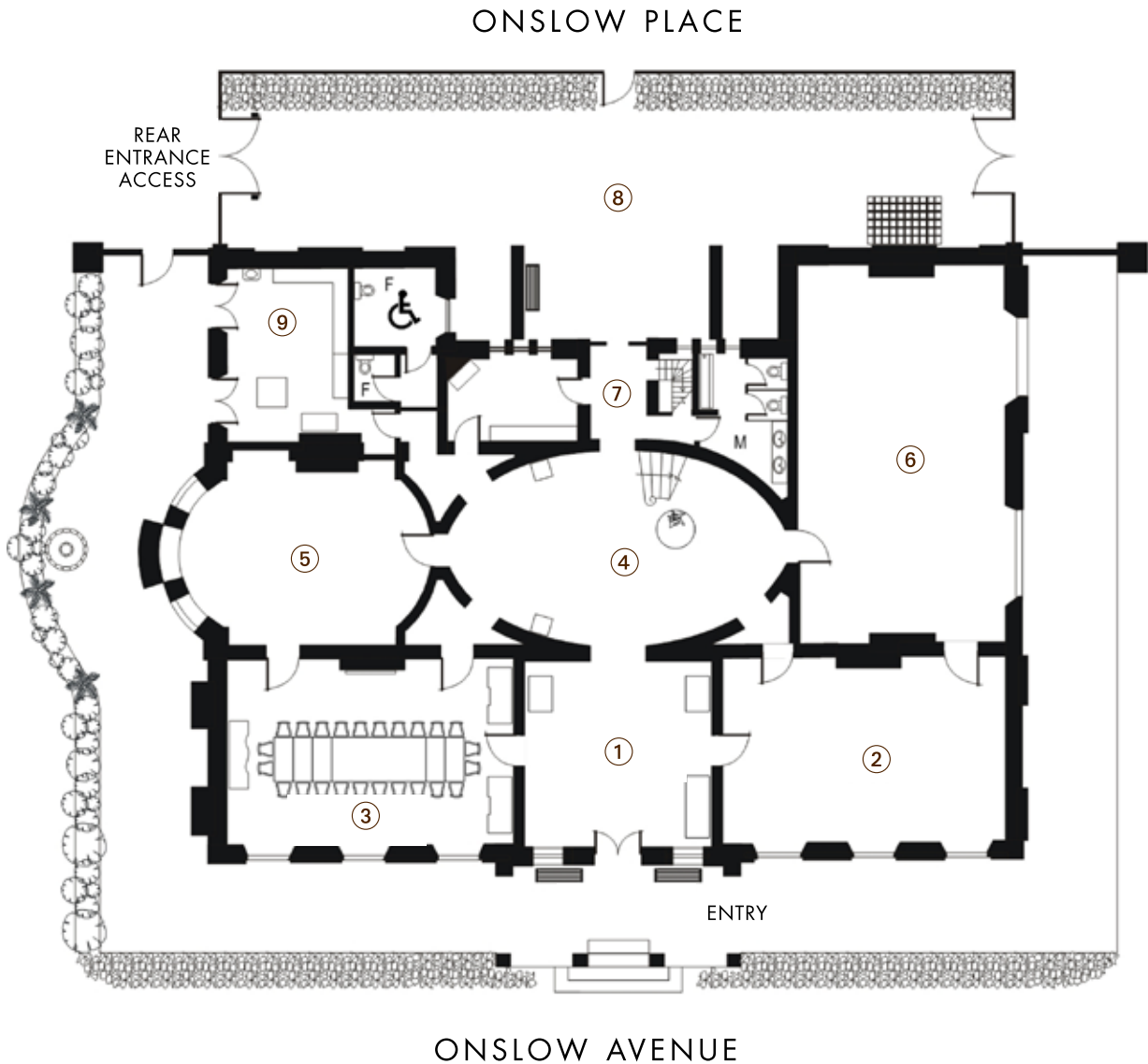

- ① Hall
- ② Drawing room
- ③ Dining room
- ④ Saloon
- ⑤ Breakfast room
- ⑥ Library
- ⑦ Butlers pantry
- ⑧ Courtyard
- ⑨ Kitchen